

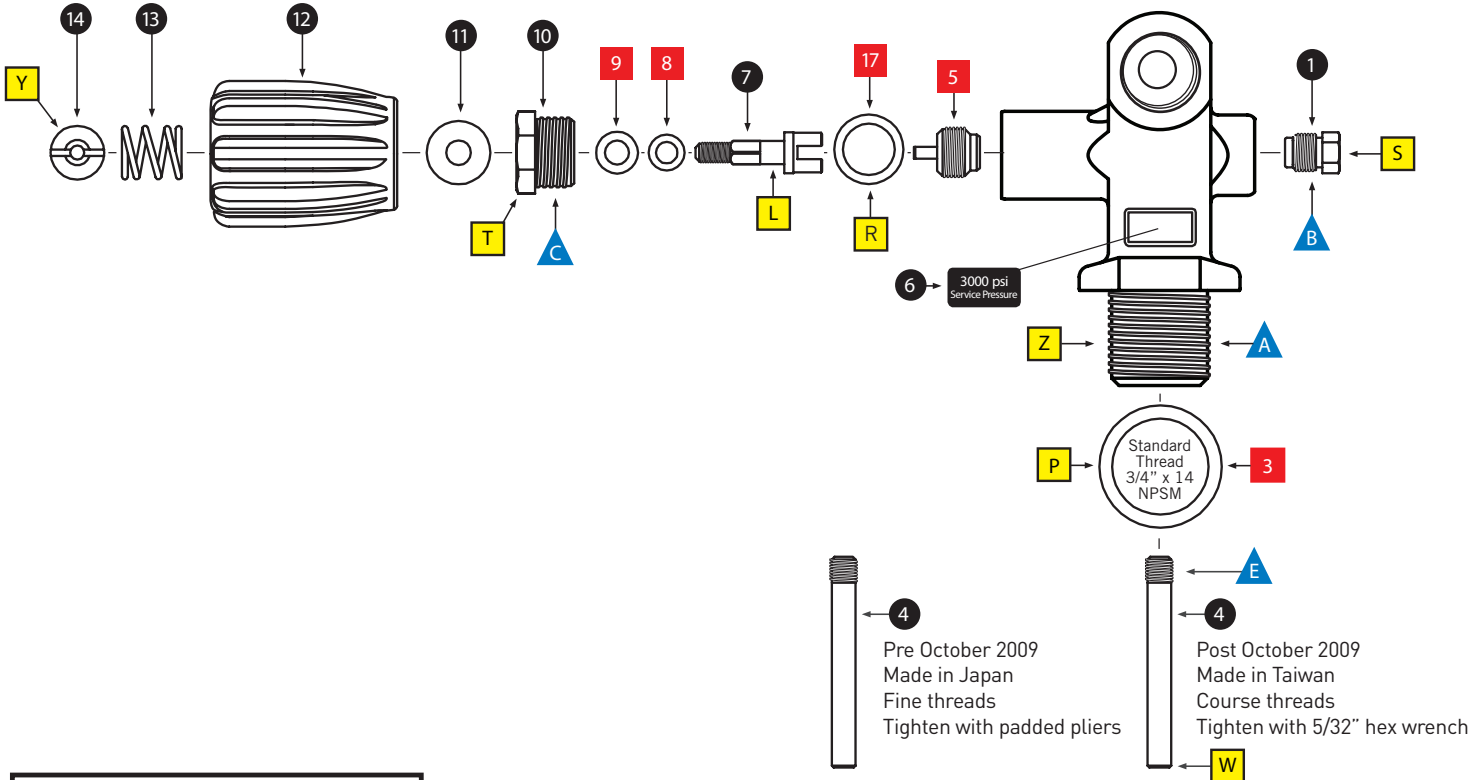

DIN VALVE EXPLODED VIEW

*** WARNING *** COMPRESSED AIR ONLY *** WARNING ***

Never use this product with any gas in which the concentration of oxygen exceeds 21%. Failure to follow this warning may result in fire, explosion, injury and/or death.



Torque Specifications

- A** Valve to Cylinder - 50 to 75 foot pounds
- B** Safety Assembly - 80 inch pounds
- C** Bonnet - 400 inch pounds
- E** Dip Tube - 40 inch pounds

Service Kit Thermo DIN Valve

Part # VKT-D
Dealer 8.00

Includes:
3 5
8 9 17

#	Part #	Description	Dealer	#	Part #	Description	Dealer
1	VP01-20	Safety Assembly 2015 psi (3358 burst)	4.00	6	VP01S-30	Sticker - 3000 psi	0.25
1	VP01-22	Safety Assembly 2250 psi (3750 burst)	4.00	6	VP01S-33	Sticker - 3300 psi	0.25
1	VP01-24	Safety Assembly 2400 psi (4000 burst)	4.00	6	VP01S-34	Sticker - 3442 psi	0.25
1	VP01-27	Safety Assembly 2730 psi (4550 burst)	4.00	6	VP01S-43	Sticker - 4350 psi	0.25
1	VP01-30	Safety Assembly 3000 psi (5000 burst)	4.00	7	VP07	Stem	4.00
1	VP01-31	Safety Assembly 3130 psi (4694 burst)	4.00	8	VP08-E	O-ring - EPDM (Stem)	1.00
1	VP01-33	Safety Assembly 3300 psi (5500 burst)	4.00	9	VP09	Teflon Washer (Stem)	1.00
1	VP01-34	Safety Assembly 3442 psi (5250 burst)	4.00	10	VT10	Bonnet - Thermo	4.00
1	VP01-43	Safety Assembly 4350 psi (7250 burst)	4.00	11	VP11	Teflon Washer (Handwheel)	1.00
3	VP03-V	O-ring - Viton (3/4" NPSM Inlet)	1.00	12	VP12-BK	Handwheel - Black	5.00
4	VT04	Dip Tube - Pre 10/09 - Fine Threads	2.00	12	VP12-GN	Replacement Handwheel - Green	6.00
4	VP04	Dip Tube - Post 10/09 - Course Threads	2.00	13	VP13	Spring	1.00
5	VP05	Seat	4.00	14	VP14	Nut	2.00
6	VP01S-20	Sticker - 2015 psi	0.25	17	VT06	Copper Crush Washer	1.00
6	VP01S-22	Sticker - 2250 psi	0.25				
6	VP01S-24	Sticker - 2400 psi	0.25				

Service Notes:

- L** Lightly lubricate with Christo-Lube MCG-111 - part number TL108
- P** Remove o-rings without damaging parts using brass pick - part number TL111
- R** Replace each time the bonnet is removed
- S** Replace Safety Assembly with 3/8" torque wrench at least once every five years at hydro test date & any time it is removed from the valve body
- T** Use 11/16" torque wrench for correct tightening
- W** Install and remove dip tube with 5/32" hex wrench
- X** Install and remove the DIN insert with 1/4" hex wrench
- Y** Remove and install nut with slotted screwdriver - part number TL113
Tighten nut until top of stem is flush with nut