

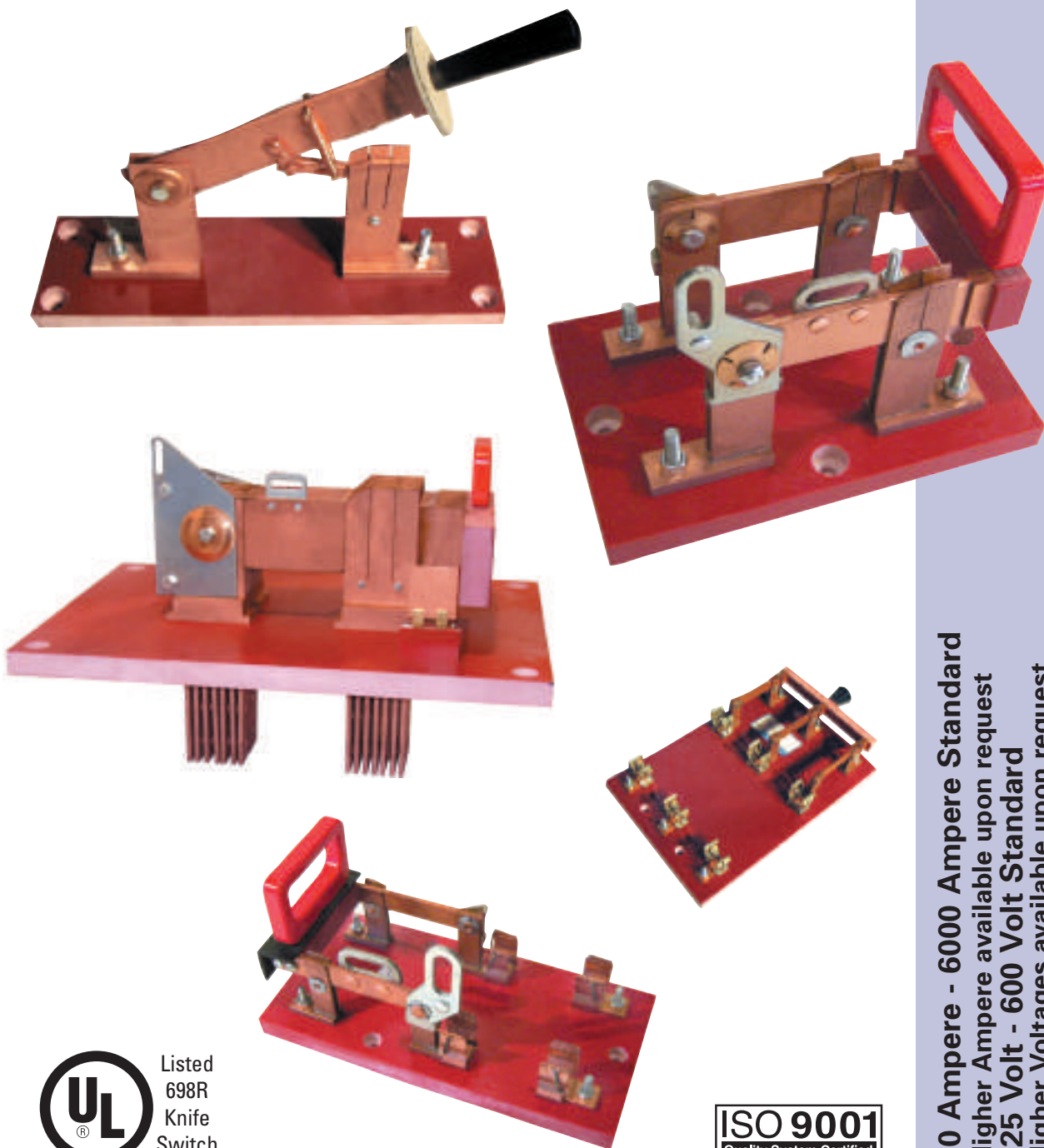

Knife Switch Product Catalog



Listed
698R
Knife
Switch



30 Ampere - 6000 Ampere Standard
Higher Ampere available upon request
125 Volt - 600 Volt Standard
Higher Voltages available upon request

Knife Switches



Knife Switch Product Catalog



SECTION A - Class 9850 - TYPE A - Front Connected Knife Switches



SECTION B - Class 9851 - TYPE D - Back Connected Knife Switches



SECTION C - Class 9852 - TYPE L - Back Connected Knife Switches



SECTION D - Class 9854 - TYPE B - Fuse Blocks



SECTION E - Dimensional Information



SECTION F - Maintenance and Installation



30 Ampere - 6000 Ampere Standard
Higher Ampere available upon request
125 Volt - 600 Volt Standard
Higher Voltages available upon request

Knife Switches

KNIFE SWITCH PRODUCT INTRODUCTION

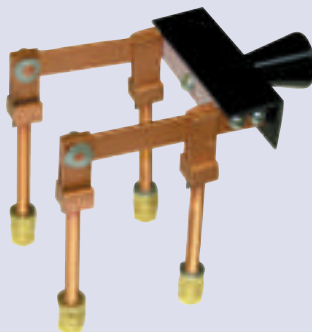
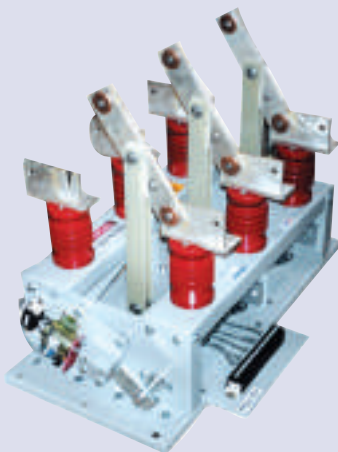
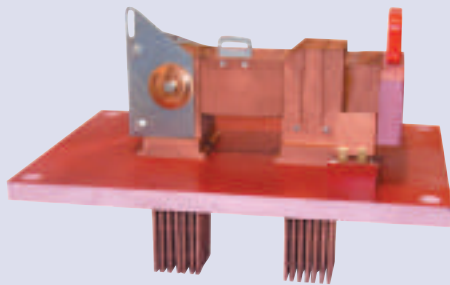
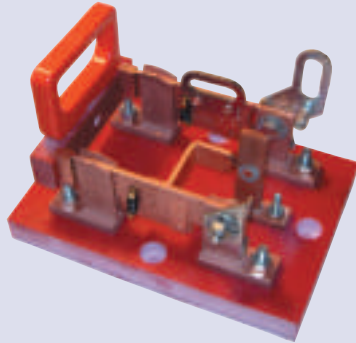

Filnor's Knife Switch product line was purchased from the Square D Company in 1974, and began production of switches in June of that year. The switch line was formerly the Barkelew Electric Company.

We have over 700 standard switches listed in our catalog. The electrical ratings on the switches range from 30 Amperes at 125 Volts AC/DC to 6000 Amperes at 600 Volts AC/DC. Construction styles are a front-connected (steel panel mounting) or back-connected (insulated panel mounting). All of these switches carry the Underwriters Laboratories Listing.

In conjunction with the standard switch line, we also build many special switch arrangements per our customers' specification. Our special switch units range in current size from 30 Amperes up through 20,000 Amperes, and Voltages up to 38,000 Volts.

Filnor is a switch supplier to a number of different industries such as transportation, utility, telecommunications, and heavy industry just to name a few. Our industry coverage lies from the large steel producers to the small marine diving companies.

With our many years of experience building standard and special switch units, Filnor is highly capable of fulfilling your switch needs.





SECTION A - Class 9850 - TYPE A - Front Connected Knife Switches 3

Introduction to Type A 4
30 Ampere, 125 Volt 5
Single-Throw, Not-Fusible 6
Double-Throw, Not-Fusible 7
Single-Throw, Fusible 8
Double-Throw, Fusible 9
Field Discharge, Polarity Reversing 10
Auxiliary Switches & Padlocking Features Options 11
Handles Options 12

SECTION B - Class 9851 - TYPE D - Back Connected Knife Switches 13

Introduction to Type A 14
30 Ampere, 125 Volt 15
Single-Throw, Not-Fusible 16
Double-Throw, Not-Fusible 17
Single-Throw, Fusible 18
Double-Throw, Fusible 19
Field Discharge, Polarity Reversing 20
Single or Double-Throw, Not-Fusible Dimensions 21 - 22
Single or Double-Throw, Field Discharge, Not-Fusible Drawing & Dimensions 23
Single-Throw, Fusible at Bottom Drawing 24
Single-Throw, Fusible at Bottom Dimensions 25

SECTION C - Class 9852 - TYPE L - Back Connected Knife Switches 26

Introduction to Type L 27
Single-Throw, Not-Fusible 28
Double-Throw, Not-Fusible 29
Polarity Reversing 30
Single or Double-Throw, Not-Fusible Drawing & Dimensions 31 - 32

SECTION D - Class 9854 - TYPE B - Fuse Blocks 33

Fuse Blocks & Fuse Holders (For National Electric Code Fuses) 34
800-6000 Ampere Fuse Blocks (For Class L Fuses) 35
Terminal Pad Dimensions (For 800-6000 Ampere Fuse Blocks)..... 36
Rectifier Fuse Blocks 37

SECTION E - Dimensional Information 38

Drawings & Dimensions 39 - 68

SECTION F - Maintenance and Installation 69

Maintenance Instructions 69
Instructions for Installing Unmounted Knife Switches on Panels 70

Class 9850 Front Connected Knife Switches Type A

SECTION A

ORDERING INFORMATION REQUIRED

1. Class, Type Number, and Part Letters (if any) of Switch.
2. Voltage and Ampere Rating.
3. If special features other than listed in Section A7 of the Price List are desired, order as Class 9850 similar to Type _____, Part # _____, except _____ (clearly describe special feature).

Receive Quotes Online

TYPE A FRONT-CONNECTED, HEAVY-DUTY KNIFE SWITCHES

Open Knife Switches are used as disconnect switches on switchboards, distribution and control panels. End users include steel mills, utility plants, transportation industry, and mining equipment.

A-1109 P2GE

400 Ampere, 250 Volt, Two-Pole, Single-Throw Switch With Padlocking Attachment, 90 degree stop & Spade Handle

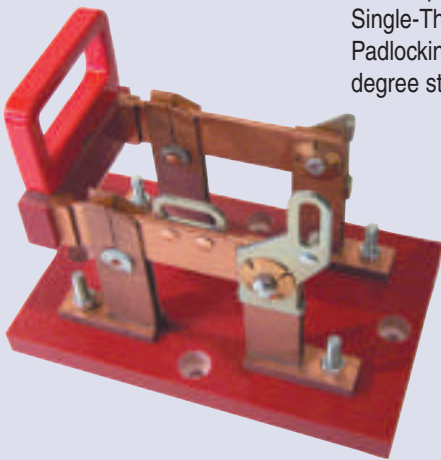

A-1142 P2GE

30 Ampere, 250 Volt, Two-Pole, Single-Throw Switch With Padlocking Attachment, 90 degree stop & Spade Handle, Fusible

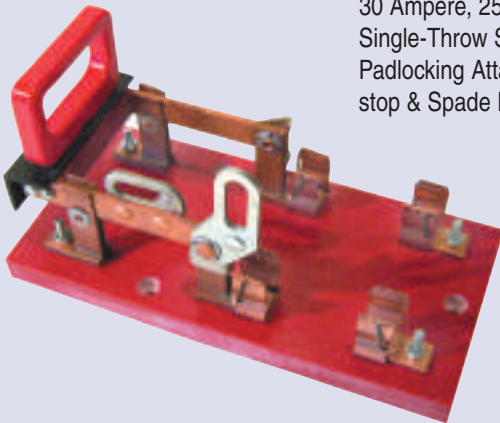

Type A, single-throw and double-throw, not-fusible knife switches have a corrosion resistant finish, are mounted on GPO-3 bases and have high clips and hinges. The high clips and hinges simplify the front-of-board connections. Available 30 Amp thru 2000 Amp.

Fusible Type A knife switches are arranged with fuse holders which will accept standard Class H or RK5 fuses. When mounted on a panel the single-throw switch is fusible at the bottom. Available 30 Amp through 600 Amp at 125, 250, 480 or 600 volt.

Ratings: Ampere ratings of Type A, not fusible, knife switches are based on a temperature rise of not more than 30 degrees C. above an ambient temperature of not more than 40 degrees C. when mounted in open air. Enclosed ratings are based on the switches being mounted in enclosures with adequate ventilation and with bus or cable of appropriate size.

Our standard switches are designed to Underwriters Labs. Knife Switches Standard U.L 363 and are listed as



Listed
698R
Knife
Switch

TYPE A FRONT-CONNECTED KNIFE SWITCHES

30 Ampere 125 Volt AC / DC Knife Switches

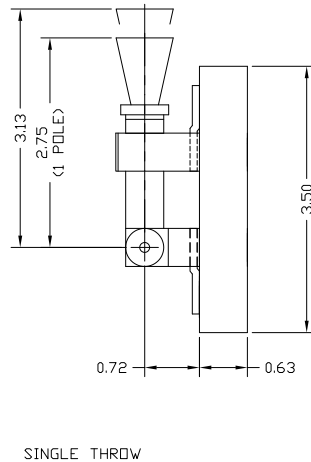
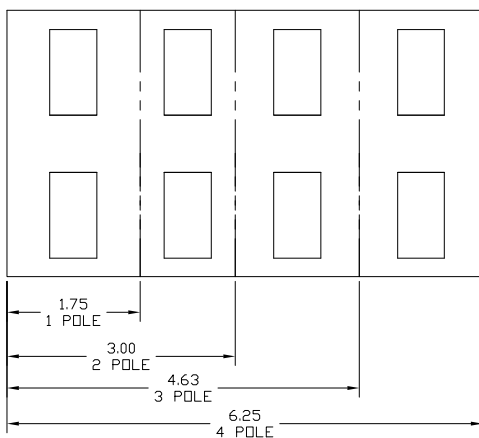

A-10S

Single-Pole, Single-Throw Switch

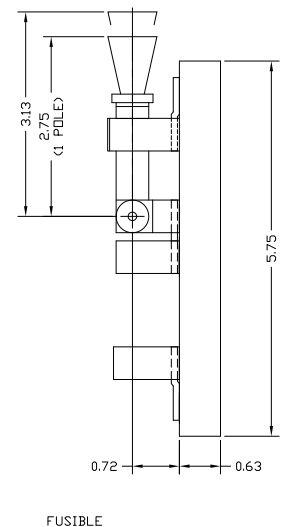
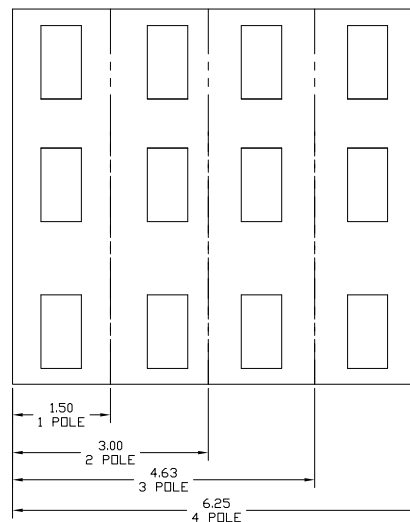
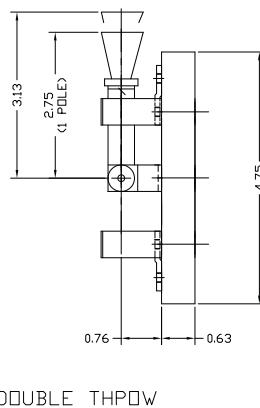
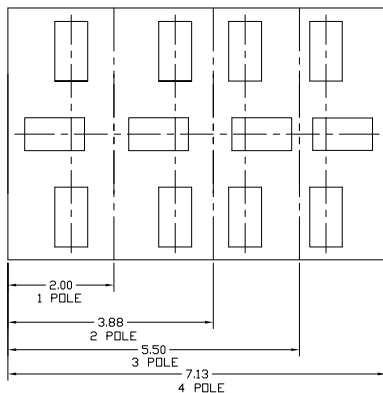
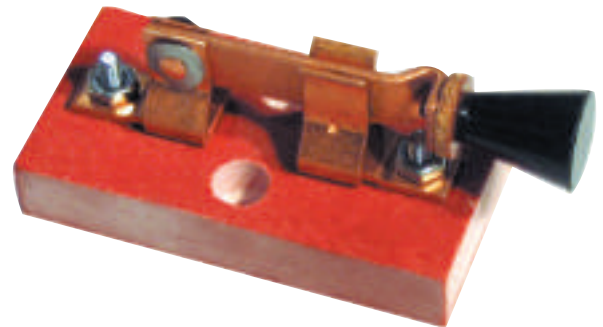

Poles	Single Throw	Double Throw	Fusible
	Cat No	Cat No	Cat No
1	A-10S	A-14D	A-18F
2	A-11S	A-15D	A-19F
3	A-12S	A-16D	A-20F
4	A-13S	A-17D	A-21F

- 30 Ampere 125 Volt Disconnects Front Connected
- For additional dimensional information please contact the factory.

Receive Quotes Online

Filnor, Inc. • 227 N. Freedom • P.O. Box 2328 • Alliance, Ohio 44601 • 330.821.7667 • f-330.829.3175

www.filnor.com • sales@filnor.com • info@filnor.com

TYPE A FRONT-CONNECTED, HEAVY-DUTY KNIFE SWITCHES Single-Throw, Not Fusible

A-1111 P2GE

600 Ampere, 250 Volt DC,
Two-Pole, Single-Throw
Switch, With Padlock Feature,
90° Stop, Not Fusible

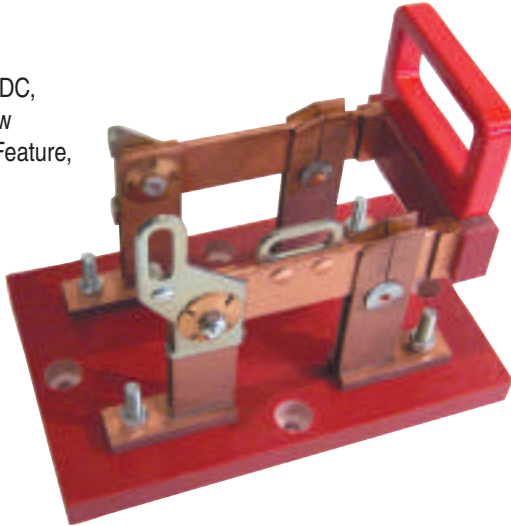

Open knife switches are used as disconnect switches mounted on switchboards, distribution and control panel boards. Extensive use of knife switches are found in the heavy industries and laboratories, for control and test panels, where visible disconnects are required.

Type A, single-throw, not-fusible knife switches have a corrosion resistant finish, are mounted on GPO-3 bases and have high clips and hinges. The high clips and hinges simplify the front-of-board connections.

SINGLE-THROW

Ampere Rating	One Pole			Two Pole			Three Pole			Four Pole		
	Type	Weight	Drawing	Type	Weight	Drawing	Type	Weight	Drawing	Type	Weight	Drawing
250 VOLT DC & 480 VOLT AC												
*30	A-1002	1/2	Refer to Section E Figure 1	A-1102	1 1/2	Refer to Section E Figure 2	A-1202	3	Refer to Section E Figure 3	A-1302	4	Refer to Section E Figure 4
60	A-1003	3/4		A-1103	3 1/4		A-1203	4 1/2		A-1303	8	
60	N/A	N/A		A-1104-B	3 1/4		N/A	N/A		N/A	N/A	
100	A-1005	2 3/4		A-1105	5 3/4		A-1205	8 1/2		A-1305	12 1/2	
200	A-1007	4 1/2		A-1107	10 1/2		A-1207	15 1/2		A-1307	20	
300	A-1008	7		A-1108	13		A-1208	19		A-1308	23	
400	A-1009	10		A-1109	19		A-1209	30		A-1309	34	
600	A-1011	15		A-1111	24		A-1211	35		A-1311	48	
800	A-1012	24		A-1112	41		A-1212	58		A-1312	76	
1200	A-1014	29		A-1114	50		A-1214	75		A-1314	96	
1600	A-1015	34		A-1115	57		A-1215	86		A-1315	110	
2000	A-1016	48		A-1116	83		A-1216	105		A-1316	140	
600 VOLT DC & AC												
30	A-6711	2 1/4	Refer to Section E Figure 5	A-6721	5 1/4	Refer to Section E Figure 6	A-6731	7	Refer to Section E Figure 7	A-6741	10	Refer to Section E Figure 8
60	A-6712	2 1/2		A-6722	5 3/4		A-6732	8		A-6742	11	
100	A-6713	3 1/2		A-6723	9		A-6733	14 1/2		A-6743	20	
200	A-6714	6		A-6724	14 3/4		A-6734	25		A-6744	33	
300	A-6710	9		A-6720	18		A-6730	30		A-6740	40	
400	A-6715	10		A-6725	26		A-6735	45		A-6745	50	
600	A-6716	14		A-6726	32		A-6736	54		A-6746	72	
800	A-6717	27		A-6727	47		A-6737	66		A-6747	87	
1200	A-6719	33		A-6729	57 1/2		A-6739	86		A-6749	110	
1600	A-1015Y	36		A-1115Y	59		A-1215Y	88		A-1315Y	112	
2000	A-1016Y	50		A-1116Y	85		A-1216Y	107		A-1316Y	142	

* 250 volt DC & AC

For 30 ampere 480 volt AC use 60 ampere switch.

Prices for 600 Volt Switches include quick break blades as required by U.L. on all switches over 100 Amperes.

Weight in pounds (lbs.)

Dimensions in Inches (in.)

FOR OPTIONS AND SPECIAL FEATURES REFER TO PAGE 14 IN SECTION A

TYPE A FRONT-CONNECTED, HEAVY-DUTY KNIFE SWITCHES Double-Throw, Not Fusible

A-2014

1200 Ampere, One-Pole, Double-Throw Switch, 250 Volt, Not Fusible



Type A, double-throw, not-fusible knife switches are similar in construction to the single-throw version. For applications where it is necessary to manually transfer between two power supplies or two loads, the double-throw switches are particularly well suited.

DOUBLE-THROW

Ampere Rating	One Pole			Two Pole			Three Pole			Four Pole		
	Type	Weight	Drawing	Type	Weight	Drawing	Type	Weight	Drawing	Type	Weight	Drawing
250 VOLT DC & 480 VOLT AC												
*30	A-2002	1 1/2	Refer to Section E Figure 9	A-2102	2	Refer to Section E Figure 10	A-2202	4	Refer to Section E Figure 11	A-2302	6	Refer to Section E Figure 12
60	A-2003	2 1/4		A-2103	6		A-2203	8		A-2303	13	
100	A-2005	3 3/4		A-2105	9 1/2		A-2205	13		A-2305	19	
200	A-2007	6		A-2107	16 1/2		A-2207	23		A-2307	30	
300	A-2008	9		A-2108	19		A-2208	33		A-2308	36	
400	A-2009	13		A-2109	26		A-2209	46		A-2309	54	
600	A-2011	22		A-2111	35		A-2211	54		A-2311	74	
800	A-2012	36		A-2112	65		A-2212	94		A-2312	115	
1200	A-2014	44		A-2114	78		A-2214	125		A-2314	150	
1600	A-2015	55		A-2115	94		A-2215	141		A-2315	175	
2000	A-2016	72		A-2116	126		A-2216	170		A-2316	220	
600 VOLT DC & AC												
30	A-7711	2 3/4	Refer to Section E Figure 13	A-7721	10	Refer to Section E Figure 14	A-7731	15	Refer to Section E Figure 15	A-7741	20	Refer to Section E Figure 16
60	A-7712	3		A-7722	11		A-7732	16 1/2		A-7742	21 1/2	
100	A-7713	5		A-7723	15		A-7733	24		A-7743	32	
200	A-7714	9		A-7724	22		A-7734	38		A-7744	51	
300	A-7710	15		A-7720	28		A-7730	45		A-7740	60	
400	A-7715	17		A-7725	38		A-7735	68		A-7745	90	
600	A-7716	22		A-7726	50		A-7736	80		A-7746	110	
800	A-7717	41		A-7727	74		A-7737	108		A-7747	132	
1200	A-7719	50		A-7729	89		A-7739	139		A-7749	170	
1600	A-2015Y	57		A-2115Y	96		A-2215Y	143		A-2315Y	177	
2000	A-2016Y	74		A-2116Y	128		A-2216Y	172		A-2316Y	222	

* 250 volt DC & AC

For 30 Ampere 480 Volt AC use 60 Ampere switch.

Prices for 600 Volt switches include quick break blades as required by U.L. on all switches over 100 Amperes.

Weight in Pounds (lbs.) Dimensions in Inches (in.)

FOR OPTIONS AND SPECIAL FEATURES REFER TO PAGE 14 IN SECTION A

Receive Quotes Online

Filnor, Inc. • 227 N. Freedom • P.O. Box 2328 • Alliance, Ohio 44601 • 330.821.7667 • f-330.829.3175

www.filnor.com • sales@filnor.com • info@filnor.com

TYPE A FRONT-CONNECTED, HEAVY-DUTY KNIFE SWITCHES Single-Throw, Fusible

A-1142 P2GE

30 Ampere, 250 Volt, Two-Pole,
Single-Throw Switch With
Padlocking Attachment, 90 degree
Stop & Spade Handle, Fusible



Fusible Type A knife switches are arranged with fuse holders which will accept standard National Electric Code fuses. When mounted on a panel the single-throw switch is fusible at the bottom.

NOTE: Standard fusible switches for Class "H" or "RK-5" fuses.

SINGLE-THROW

Ampere Rating	One Pole			Two Pole			Three Pole			Four Pole		
	Type	Weight	Drawing	Type	Weight	Drawing	Type	Weight	Drawing	Type	Weight	Drawing
250 VOLT DC & AC												
30	A-1042	3/4	Refer to Section E Figure 17	A-1142	1 1/2	Refer to Section E Figure 18	A-1242	3 1/2	Refer to Section E Figure 19	A-1342	6 1/4	Refer to Section E Figure 20
60	A-1043	1 1/2		A-1143	3		A-1243	6 1/2		A-1343	10 3/4	
100	A-1045	5 1/2		A-1145	9		A-1245	14		A-1345	21	
200	A-1047	9		A-1147	17		A-1247	24		A-1347	37	
400	A-1049	16		A-1149	29		A-1249	48		A-1349	67	
600	A-1051	22		A-1151	44		A-1251	60		A-1351	88	
480 VOLT AC												
30	A-6511	3	Refer to Section E Figure 21	A-6521	6	Refer to Section E Figure 22	A-6531	7 1/2	Refer to Section E Figure 23	A-6541	12	Refer to Section E Figure 24
60	A-6512	5		A-6522	9 1/2		A-6532	8 3/4		A-6542	19	
100	A-6513	8		A-6523	14		A-6533	17		A-6543	27	
200	A-6514	10		A-6524	20		A-6534	25		A-6544	42	
400	A-6515	17		A-6525	35		A-6535	50		A-6545	72	
600	A-6516	22		A-6526	47		A-6536	65		A-6546	91	
600 VOLT DC & AC												
30	A-6914	3 1/2	Refer to Section E Figure 25	A-6924	8 3/4	Refer to Section E Figure 26	A-6934	15	Refer to Section E Figure 27	A-6944	20	Refer to Section E Figure 28
60	A-6915	4 1/2		A-6925	9 1/2		A-6935	16		A-6945	21	
100	A-6916	8 1/2		A-6926	19		A-6936	31		A-6946	41	
200	A-6917	17		A-6927	32		A-6937	48		A-6947	64	
400	A-6918	28		A-6928	49		A-6938	72		A-6948	96	
600	A-6919	36		A-6929	62		A-6939	90		A-6949	120	

Prices for 600 Volt switches include quick break blades as required by U.L. on all switches over 100 Amperes. Prices do not include fuses.

FOR OPTIONS AND SPECIAL FEATURES REFER TO PAGE 14 IN SECTION A

Receive Quotes Online

Filnor, Inc. • 227 N. Freedom • P.O. Box 2328 • Alliance, Ohio 44601 • 330.821.7667 • f-330.829.3175

www.filnor.com • sales@filnor.com • info@filnor.com

TYPE A FRONT-CONNECTED, HEAVY-DUTY KNIFE SWITCHES Double-Throw, Fusible

A-2227

200 Ampere, Three-Pole, Double-Throw, Fusible Switch, Both Throws

Fusible Type A double throw knife switches are fusible on both throws. In order to provide clearance between the handle and the fuses, these switches are constructed with low hinges and high clips.



DOUBLE-THROW

Ampere Rating	One Pole			Two Pole			Three Pole			Four Pole		
	Type	Weight	Drawing	Type	Weight	Drawing	Type	Weight	Drawing	Type	Weight	Drawing
250 VOLT DC & AC												
*30	A-2022	3	Available Upon Request	A-2122	5	Available Upon Request	A-2222	7	Available Upon Request	A-2322	12	Available Upon Request
60	A-2023	6		A-2123	8		A-2223	13		A-2323	19	
100	A-2025	9		A-2125	15		A-2225	26		A-2325	40	
200	A-2027	15		A-2127	25		A-2227	46		A-2327	67	
400	A-2029	27		A-2129	49		A-2229	88		A-2329	117	
600	A-2031	35		A-2131	74		A-2231	117		A-2331	166	
480 VOLT AC												
30	A-7411	3 1/2	Available Upon Request	A-7421	10	Available Upon Request	A-7431	10	Available Upon Request	A-7441	23	Available Upon Request
60	A-7412	5 1/2		A-7422	14		A-7432	15		A-7442	35	
100	A-7413	10		A-7423	25		A-7433	28		A-7443	60	
200	A-7414	15		A-7424	33		A-7434	49		A-7444	74	
400	A-7415	28		A-7425	60		A-7435	93		A-7445	127	
600	A-7416	42		A-7426	75		A-7436	127		A-7446	146	
600 VOLT DC & AC												
30	A-7814	9 1/2	Available Upon Request	A-7824	15	Available Upon Request	A-7834	26	Available Upon Request	A-7844	35	Available Upon Request
60	A-7815	10		A-7825	16		A-7835	27		A-7845	38	
100	A-7816	15		A-7826	30		A-7836	52		A-7846	70	
200	A-7817	28		A-7827	50		A-7837	76		A-7847	102	
400	A-7818	42		A-7828	74		A-7838	100		A-7848	135	
600	A-7819	53		A-7829	90		A-7839	130		A-7849	175	

* 250 volt DC & AC

For 30 Ampere 480 Volt AC use 60 Ampere switch.

Prices for 600 Volt switches include quick break blades as required by U.L. on all switches over 100 Amperes. Prices do not include fuses.

Weight in Pounds (lbs.) Dimensions in Inches (in.)

FOR OPTIONS AND SPECIAL FEATURES REFER TO PAGE 14 IN SECTION A

Receive Quotes Online

Filnor, Inc. • 227 N. Freedom • P.O. Box 2328 • Alliance, Ohio 44601 • 330.821.7667 • f-330.829.3175

www.filnor.com • sales@filnor.com • info@filnor.com

TYPE A FRONT-CONNECTED, HEAVY-DUTY KNIFE SWITCHES Single or Double-Throw, Not Fusible

A-1261 P2GE

100 Ampere, Single-Throw Field Discharge Switch, With Padlocking Attachment, 90 degree Stop, Spade Handle

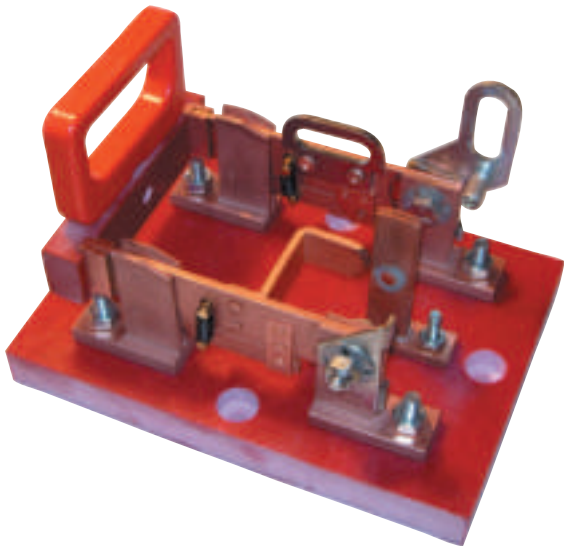

Field Discharge Switches

Field discharge switches are used to overcome the high inductive current caused by suddenly opening a generator field. When opening the generator circuit, the field discharge switch closes the field across a resistor allowing the inductive discharge to die out gradually, which might otherwise result in a rupture of field insulation.

Upon opening these two-pole switches, the discharge blade, which is an offset extension of one of the main blades, makes contact with a high clip. The high clip, which is connected to the resistor, is located between the hinges of the two blades. Another feature of the switch is each pole is equipped with quick-break blades. The discharge blade and the quick break blades combine to provide a make before break operation. Upon opening the switch, the resistance current is made before the line-to-field circuit is broken, limiting the field discharge voltage. When closing the switch, the discharge blade breaks the resistance current before the main blades make contact.

Ampere Rating	Single Throw		Double Throw	
	Type	Weight	Type	Weight
60	A-1260	4	A-1265	7
100	A-1261	6 1/2	A-1266	11
200	A-1262	12	A-1267	18

Prices do not include resistors.

Polarity Reversing Switches

Another version of the Type A knife switch is the polarity reversing switch. This switch is two-pole, double-throw, and is equipped with rocker type blades. The cross-connection used to give the reversing action is made of copper bus straps mounted between the poles on the front of the switch.

Ampere Rating	Type	Base Size (W x H)
100	A-2139R	10 1/4 x 7
200	A-2140R	15 x 7 3/4
300	A-2141R	15 x 7 3/4
400	A-2142R	17 x 10 1/4
600	A-2143R	20 x 10
800	A-2144R	20 x 14
1200	A-2145R	22 x 15
1600	A-2146R	22 x 19 3/8
2000	A-2147R	22 x 22

15 Volts DC Maximum

ORDERING INFORMATION

1. Class, Type, Number and Part letters (if any) of switch
2. Voltage and Ampere Rating
3. If special features (if other than listed in section A7) are desired, order on Class 9850, similar to Type _____, Part _____ except.

TYPE A FRONT-CONNECTED, HEAVY-DUTY KNIFE SWITCHES Options & Special Features

Auxiliary Switches Options

Micro Switch Auxiliary Style

Auxiliary switches, single-pole, double-throw, actuated when main switch is in closed position, can be added to Type A knife switches as follows:

Part Letter	Description	Price
X1	One auxiliary switch added to single-throw main switch.	\$ 145.00
X2	Two auxiliary switches added to single-throw main switch on same actuator.	\$ 245.00
X3	One auxiliary switch on each throw of double-throw main switch. Requires two auxiliary switches with one actuator.	\$ 245.00



Micro Switch Auxiliary

Knife Type Auxiliary Style

Knife type auxiliary switches, this 15 ampere, 250 volt auxiliary switch is makes contact after the main switch closes and breaks contact before the main switch opens.

Part Letter	Description	Price
A1	1-Knife type auxiliary for single-throw switch. (price from table below)	see chart
A2	2-Knife type auxiliary for single-throw switch. (price from table below)	see chart
A3	2-Knife type auxiliary for double-throw switch, one on each throw. (price from table below)	see chart
A4	4-Knife type auxiliary for double-throw switch, two on each throw. (price from table below)	

Ampere Rating	Price per auxiliary switch
30-100	\$ 56.00
200-300	\$ 80.00
400-1200	\$ 120.00
1600 & over	\$ 160.00



Knife Type Auxiliary

Padlocking Feature Options

Padlocking attachment for three locks to lock switch only in the OPEN position. NOTE: Double-throw switches to be furnished with padlocking attachment should be mounted in horizontal position to avoid the locks making contact with the switch clips. Switches also requiring 90° stops are to be priced from item P2G.

Part Letter	Description			Price	
P2	Ampere Rating	Price	Padlocking attachment in the open position.	see chart	
	30-200	\$ 32.00			
	300-600	\$ 48.00			
	800-1200	\$ 56.00			
	1600 - 2000	\$ 80.00			
G	Ampere Rating	Price	90° stops for single-throw switches. Required only on two poles of 2, 3, or 4-pole switches. Switches also requiring padlocking attachment, Form P2, are to be priced from item P2G. The following prices are for each pole requiring a stop.	see chart	
	30-200	\$ 8.00			
	300-600	\$ 16.00			
	800-1200	\$ 32.00			
	1600 - 2000	\$ 72.00			
P2G	Ampere Rating	Price 1 Pole	Price 2 - 4 Pole	Padlocking attachment as described in item P2 and 90° stops as required. This combination only applies to single-throw switches.	see chart
	30-200	\$ 32.00	\$ 40.00		
	300-600	\$ 48.00	\$ 64.00		
	800-1200	\$ 72.00	\$ 88.00		
	1600 - 2000	\$ 120.00	\$ 152.00		



P2G - Padlocking Feature with 90° Stop

TYPE A FRONT-CONNECTED, HEAVY-DUTY KNIFE SWITCHES Options & Special Features

Handles

Substitute molded spade handle on 2, 3, or 4 pole switches which are furnished with straight handles as standard. Straight handles must be furnished on all single-pole switches. Spade handles, Form E1 (see diagram below), are furnished as standard on: All 4-Pole Switches: All 3-Pole, 600 Volt Switches: All 800 Ampere and over, except Single-Pole Switches.

Option Handle Spade NOTE: Standard handle supplied is a straight handle.

Part Letter	Description	Price
E1	Spade handles on top of switch blade. See diagram for Form E1. (Price from table below)	see chart
E	Spade handles on front of switch blade. See diagram for Form E. (Price from table below)	see chart

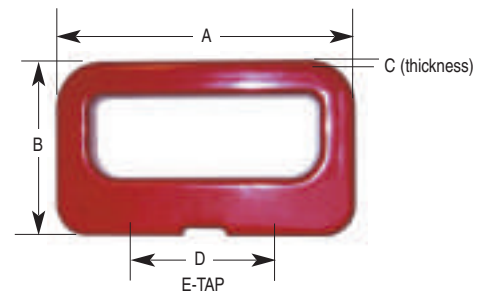
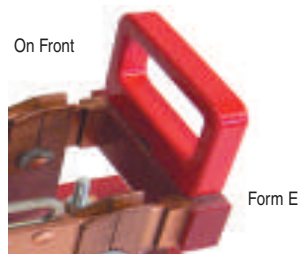

Ampere Rating	Poles	Dimensions				
		A	B	C	D	E
30-100	2 & 3	3	2	1/2	1 1/8	10 - 32
200-300	2 & 3	3 7/8	2 1/2	5/8	1 5/8	1/4 - 20
400-600	2 & 3	5 1/8	3	7/8	2	5/16 - 18
800 +	2 & 3	5 1/8	3	7/8	3 5/16	3/8 - 16

Part Letter	Description	Price
S	Lexan covers available. Consult factory for more information.	consult factory



Rocker Blades For Double-Throw Switches

Part Letter	Description			Price
R	Ampere Rating	Price	Price	Substitute rocker blades in place of standard blades on double-throw switches. The following prices are to be added for each switch pole. NOTE: The above prices are for factory installed rocker blades. For prices of rocker blades for field installation, consult the factory. For 30 Ampere 480 Volt use 60 Ampere price. see chart
		250 Volt DC 480 Volt AC	600 Volt DC & AC	
	*30	\$ 16.00	\$ 40.00	
	60	\$ 24.00	\$ 40.00	
	100	\$ 32.00	\$ 56.00	
	200	\$ 72.00	\$ 104.00	
	300	\$ 112.00	\$ 144.00	
	400	\$ 128.00	\$ 160.00	
	600	\$ 144.00	\$ 192.00	
	800	\$ 256.00	\$ 320.00	
1200	\$ 288.00	\$ 384.00		



Other Filnor Switch Products Available

Type BM Open Style Front Connected

Bolted Pressure Contact Switches

Type EBM Switches

Enclosed Bolted Pressure Switch with side operated manual handle, non-load break.

Type BPI Switches

Enclosed Bolted Pressure Switch with side operated Quick Brake Mechanism and Arc Breaking capability.

Type DB Switches

High Current Switch applications.

Medium Voltage Switches

Isolation and grounding applications. 200 - 12,000 Ampere, 5 kV - 38 kV.

Custom Designed Switches

Switches designed to suit your exact specifications.

Transfer Switches

Open or enclosed.

Please contact Filnor, Inc. for complete information on the above products, as well as additional Resistor and Control Units not listed.

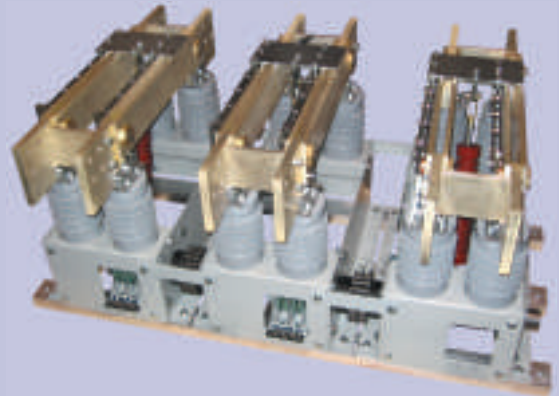

Special Design Medium Voltage Switch

6300 A, 15 kV, 3-Pole, Single Throw, Motor Operated, Medium Voltage Bolted Pressure Switch



3000 A, 250 V DC, 2-Pole, Single Throw, Fusible, Type BPI Switch Crane Rail Disconnect



Listed
698R
Knife
Switch



Knife Switch Product Catalog

Filnor, Inc.
227 North Freedom
P.O. Box 2328
Alliance, Ohio 44601
P-330.821.7667
F-330.829.3175
info@filnor.com

Please visit our website at www.filnor.com for more information on all of our product lines.



30 Ampere - 6000 Ampere Standard
Higher Ampere available upon request
125 Volt - 600 Volt Standard
Higher Voltages available upon request

Knife Switches