

# QUICK DISCONNECT COUPLERS

Hansen Two-Way Shut-Off Couplings seal both ends of line when coupling is disconnected. Spring actuated valves in both socket and plug provide immediate seal against escape of gas or liquid. Couplings can be used for compressed air, hydraulic fluid, liquids, paints, steam, refrigerants, gases, vacuum (limited), and oxygen. LP Gas and Vacuum Service is not recommended for 4-HK, 6-HK, and 8-HK Series Couplers.

## Sockets, Female NPT End Connection

SEE BELOW

Part No.	Series 1-HK 1/8 in. FNPT
Dimensions A: 2.91 in., B: 0.98 in.	
B1-H11	Brass
LL1-H11	Stainless Steel (303)
ML1-H11	Stainless Steel (316)



Part No.	Series 2-HK 1/4 in. FNPT
Dimensions A: 2.26 in., B: 1.17 in.	
B2-H16	Brass
LL2-H16	Stainless Steel (303)
ML2-H16	Stainless Steel (316)

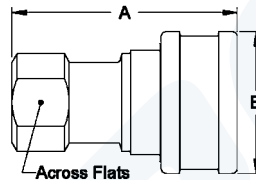

Part No.	Series 3-HK 3/8 in. FNPT
Dimensions A: 2.56 in., B: 1.42 in.	
B3-H21	Brass
LL3-H21	Stainless Steel (303)
ML3-H21	Stainless Steel (316)

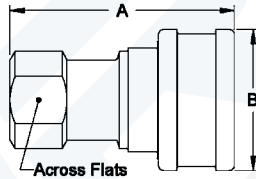

Part No.	Series 4-HK 1/2 in. FNPT
Dimensions A: 2.96 in., B: 1.86 in.	
B4-H26	Brass
LL4-H26	Stainless Steel (303)
ML4-H26	Stainless Steel (316)

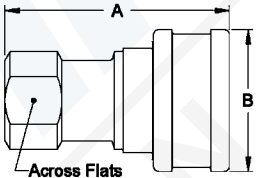

Part No.	Series 6-HK 3/4 in. FNPT
Dimensions A: 3.48 in., B: 2.22 in.	
B6-H31	Brass
LL6-H31	Stainless Steel (303)
ML6-H31	Stainless Steel (316)

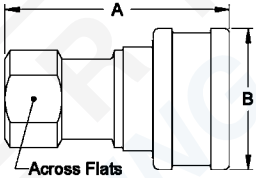

Part No.	Series 8-HK 1 in. FNPT
Dimensions A: 4.13 in., B: 2.61 in.	
B8-H36	Brass
LL8-H36	Stainless Steel (303)
ML8-H36	Stainless Steel (316)

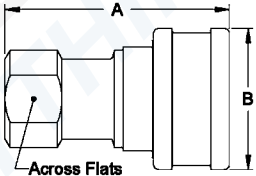

### Options

Sleeve Lock Device	For Optional Sleeve Lock Device, add suffix "-SL" to the part number.
Valve Actuators for One-Way Shut-Off Service	Sockets or Plugs in some material can be provided with valve actuator in place of Valve Assembly to allow dissipation of pressure upon disconnection. To order add suffix "-VAA".
British Parallel Pipe Thread	Series 1-HK to 8-HK available with British Parallel Pipe Thread.

	Specifications		
	Service Pressure		Flows
1-HK	3000	5000	0.5
2-HK	2700	3700	1.1
3-HK	2200	3700	1.9
4-HK	2200	4200	3.2
6-HK	2000	3000	8.2

## Plugs, Female NPT End Connection

SEE BELOW

Part No.	Series 1-HK 1/8 in. FNPT
Dimensions C: 1.26 in., D: 0.65 in.	
B1-K11	Brass
LL1-K11	Stainless Steel (303)
ML1-K11	Stainless Steel (316)



Part No.	Series 2-HK 1/4 in. FNPT
Dimensions C: 1.52 in., D: 0.87 in.	
B2-K16	Brass
LL2-K16	Stainless Steel (303)
ML2-K16	Stainless Steel (316)

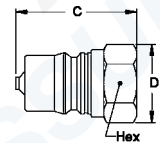

Part No.	Series 3-HK 3/8 in. FNPT
Dimensions C: 1.76 in., D: 1.01 in.	
B3-K21	Brass
LL3-K21	Stainless Steel (303)
ML3-K21	Stainless Steel (316)

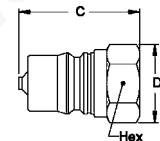

Part No.	Series 4-HK 1/2 in. FNPT
Dimensions C: 2.03 in., D: 1.30 in.	
B4-K26	Brass
LL4-K26	Stainless Steel (303)
ML4-K26	Stainless Steel (316)

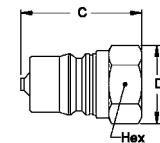

Part No.	Series 6-HK 3/4 in. FNPT
Dimensions C: 2.36 in., D: 1.52 in.	
B6-K31	Brass
LL6-K31	Stainless Steel (303)
ML6-K31	Stainless Steel (316)

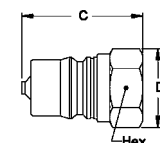

Part No.	Series 8-HK 1 in. FNPT
Dimensions C: 2.85 in., D: 1.88 in.	
B8-K36	Brass
LL8-K36	Stainless Steel (303)
ML8-K36	Stainless Steel (316)

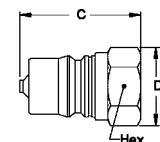

### Plastic Dust Caps for HK Series

P-SDC-1-HK	For 1-HK Socket	P-PDC-1-HK	For 1-HK Plug
P-SDC-2-HK	For 2-HK Socket	P-PDC-2-HK	For 2-HK Plug
P-SDC-3-HK	For 3-HK Socket	P-PDC-3-HK	For 3-HK Plug
P-SDC-4-HK	For 4-HK Socket	P-PDC-4-HK	For 4-HK Plug
P-SDC-6-HK	For 6-HK Socket	P-PDC-6-HK	For 6-HK Plug
P-SDC-8-HK	For 8-HK Socket	P-PDC-8-HK	For 8-HK Plug

ANY PLUG AND SOCKET FROM THE SAME SERIES, REGARDLESS OF END CONNECTIONS, FIT TOGETHER TO MAKE A COUPLING ASSEMBLY.